

Conversion from Bosch CDI to MSD
 Bill of materials as installed in a 1974 911
 Matt Switzer - August, 2008

• PN 6421	MSD 6AL-2 Ignition control with Built-in 2-Step rev control – with rotary dials	1
• PN 8920	MSD Tach Adapter	1
• PN 8222	MSD Blaster Coil	1
• PN 8181	MSD 4-Pin Deutsch Connector, 16 gauge	2
• PN 8183	MSD 2-Pin Deutsch Connector, 16 gauge	1
• PN 8184	MSD 2-Pin Deutsch Connector, 12-14 gauge	1
• PN 91867	Pertronix Ignitor II	1
• PEL-MAGN65-83	Magnecor Wire Set including coil wire, KV85	1
• CE-9191-18	Spark Plug Wire Separator - 8.5mm	6
• n/a	Adapter plate, Bosch CDI to MSD. See provided drawing.	1
• n/a	Adapter plate, Fuel accumulator/filter. See provided drawing.	1
• 94648A340	18-8 Stainless Steel Broach Captive Nut 8-32 Screw Size.	7
• n/a	¼" braided wire sheath, as needed	
• n/a	½" braided wire sheath, as needed	
• n/a	Assorted heat shrink tubing as needed.	
• n/a	Solder as needed.	

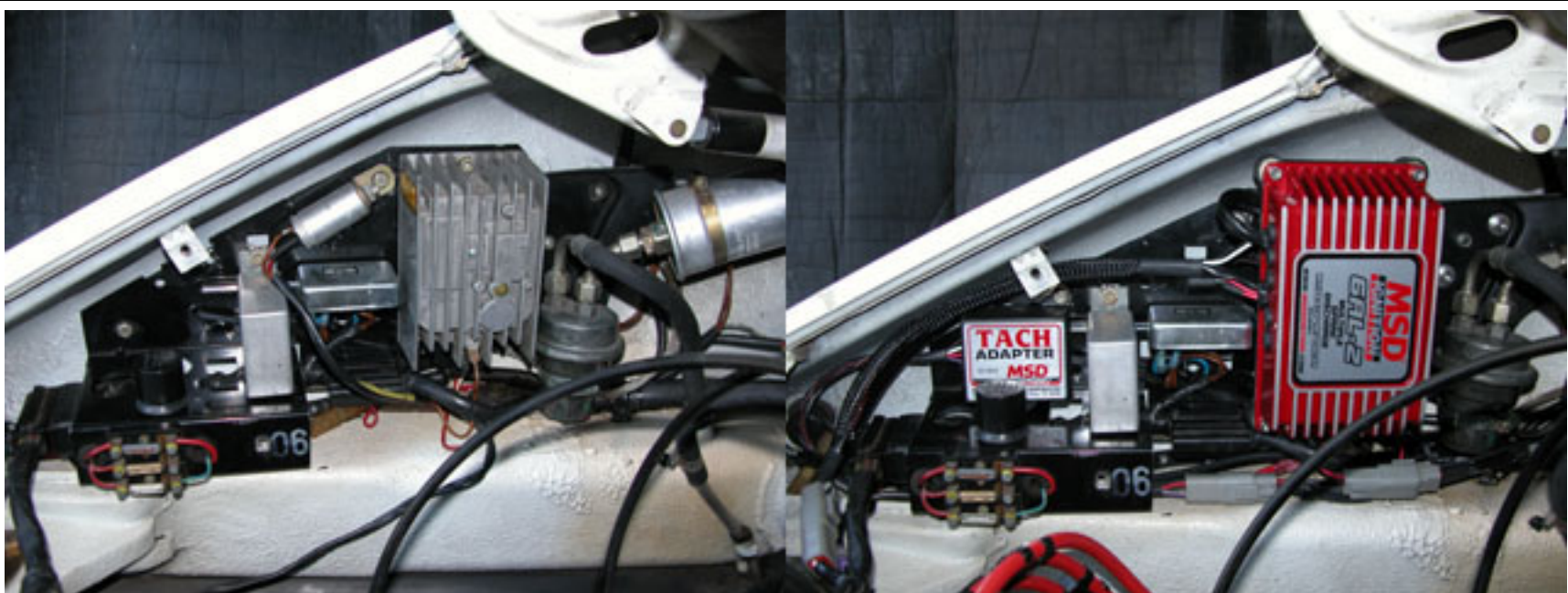

Before

After

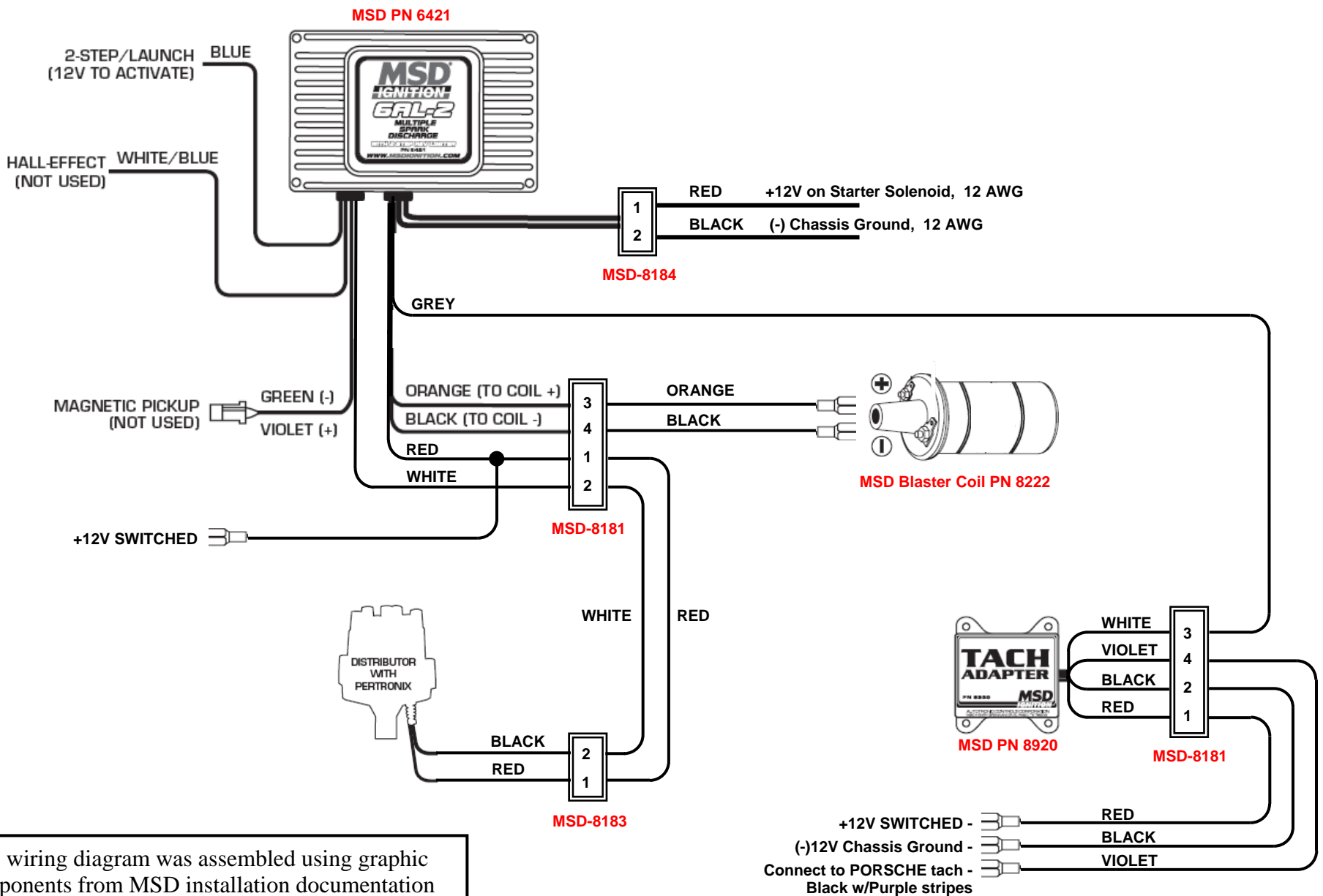

This wiring diagram was assembled using graphic components from MSD installation documentation which was laid out and labelled as installed in a 1974 Porsche 911. This diagram worked for its creator, if you choose to use it, do so at your own risk.

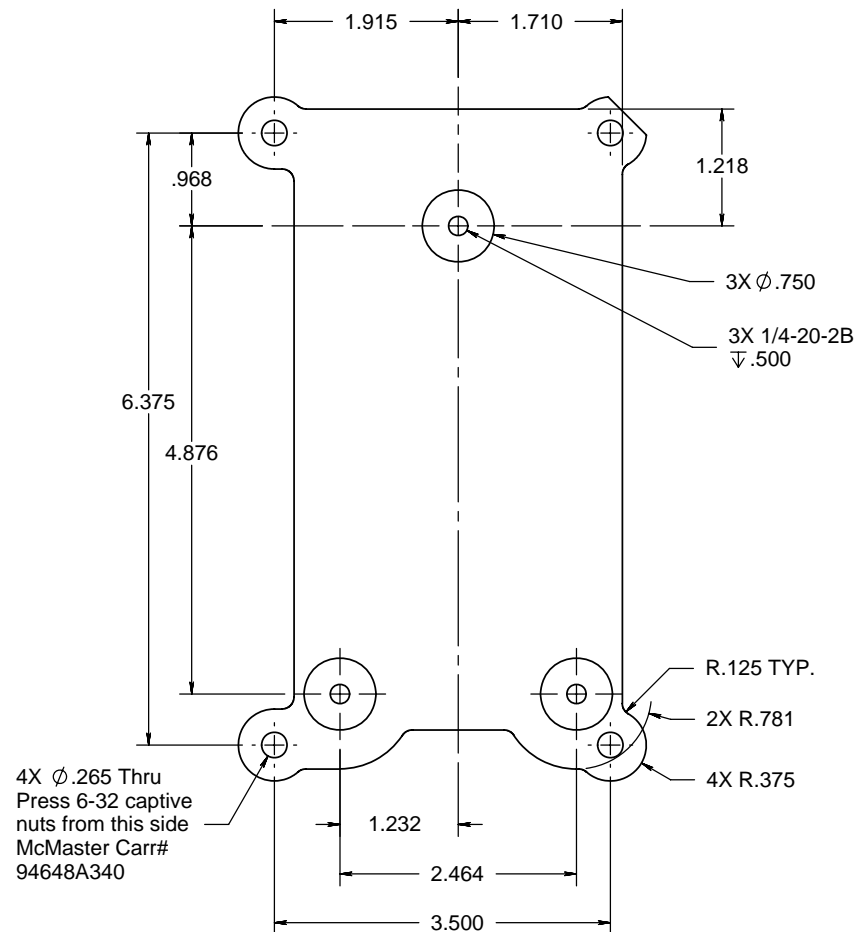
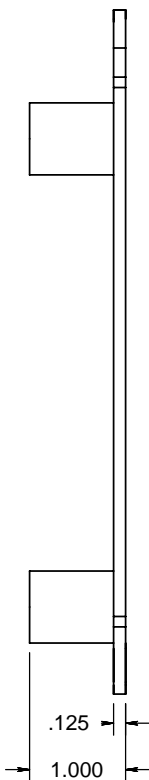
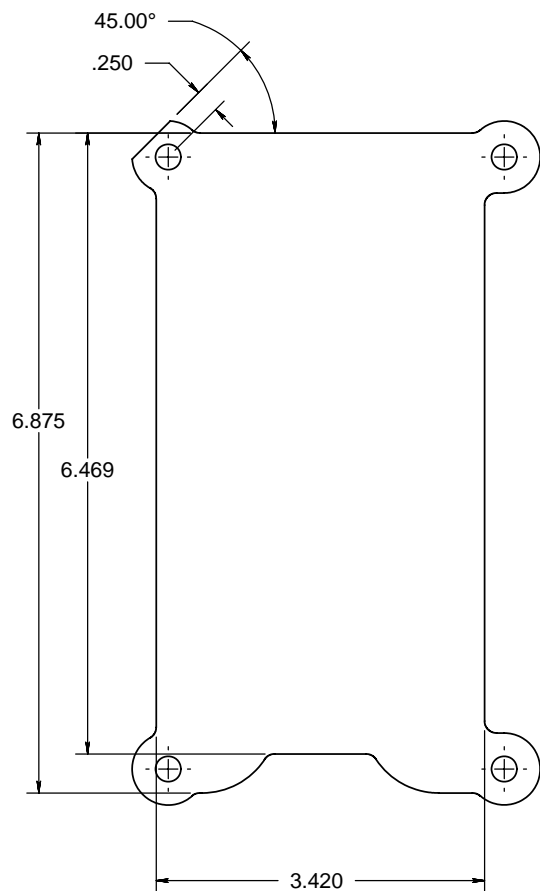
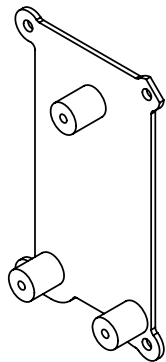

4X Ø.265 Thru
Press 6-32 captive
nuts from this side
McMaster Carr#
94648A340

PROPRIETARY AND CONFIDENTIAL
THE INFORMATION CONTAINED IN THIS DRAWING IS THE SOLE PROPERTY OF SwitzeRC. ANY REPRODUCTION IN PART OR AS A WHOLE WITHOUT THE WRITTEN PERMISSION OF SwitzeRC IS PROHIBITED.

		UNLESS OTHERWISE SPECIFIED:		NAME	DATE
		DIMENSIONS ARE IN INCHES	DRAWN	M. Switzer	8/12/2008
		TOLERANCES:	CHECKED		
		FRACTIONAL ±	ENG APPR.		
		ANGULAR: MACH ± BEND ±	MFG APPR.		
		TWO PLACE DECIMAL ±	Q.A.		
		THREE PLACE DECIMAL ±	COMMENTS:		
		INTERPRET GEOMETRIC TOLERANCING PER:			
		MATERIAL			
		Aluminum 6061-T6			
NEXT ASSY	USED ON	FINISH			
APPLICATION		DO NOT SCALE DRAWING			

TITLE:
**Adapter Plate
Bosch CDI to MSD**

SIZE **A** DWG. NO. 74911 CDI to MSD Plate Rev 00

SCALE: 1:2 WEIGHT: SHEET 1 OF 3

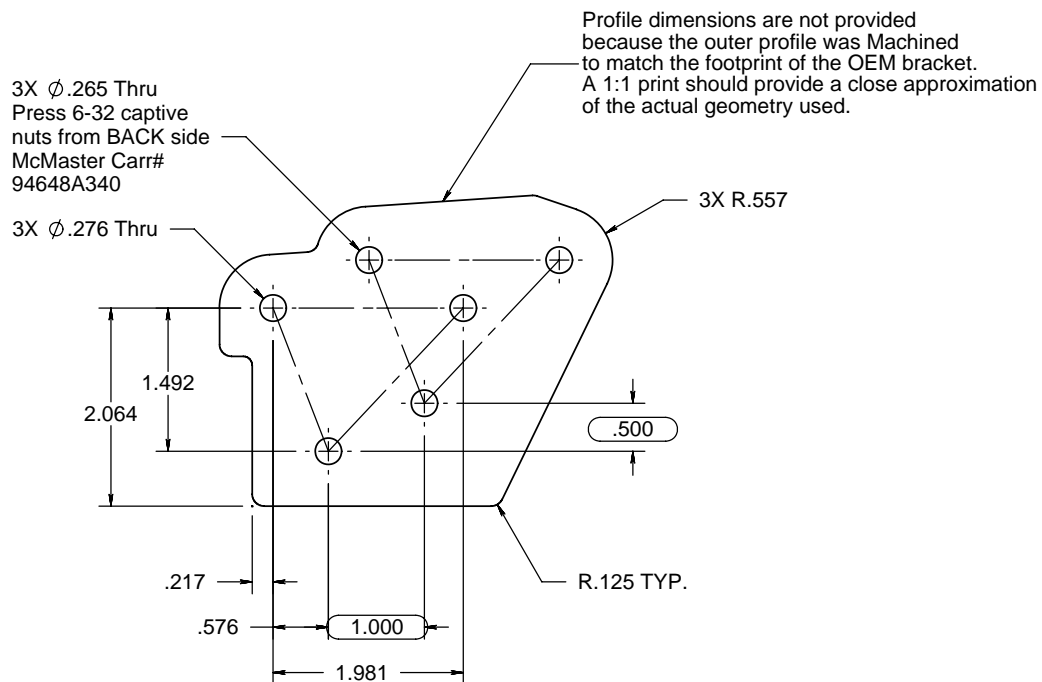
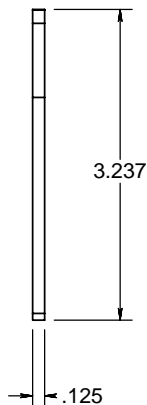
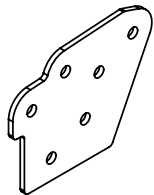

PROPRIETARY AND CONFIDENTIAL
 THE INFORMATION CONTAINED IN THIS DRAWING IS THE SOLE PROPERTY OF SwitzeRC. ANY REPRODUCTION IN PART OR AS A WHOLE WITHOUT THE WRITTEN PERMISSION OF SwitzeRC IS PROHIBITED.

		UNLESS OTHERWISE SPECIFIED:		NAME	DATE	TITLE: Adapter Plate Fuel Accumulator/Filter
		DIMENSIONS ARE IN INCHES	DRAWN	M. Switzer	8/12/2008	
		TOLERANCES: FRACTIONAL ±	CHECKED			
		ANGULAR: MACH ± BEND ±	ENG APPR.			
		TWO PLACE DECIMAL ± THREE PLACE DECIMAL ±	MFG APPR.			
		INTERPRET GEOMETRIC TOLERANCING PER:	Q.A.			SIZE DWG. NO. A 74911 CDI to MSD Plate Rev 00
		MATERIAL Aluminum 6061-T6	COMMENTS:			
NEXT ASSY	USED ON	FINISH				
APPLICATION		DO NOT SCALE DRAWING		SCALE: 1:2		SHEET 2 OF 3

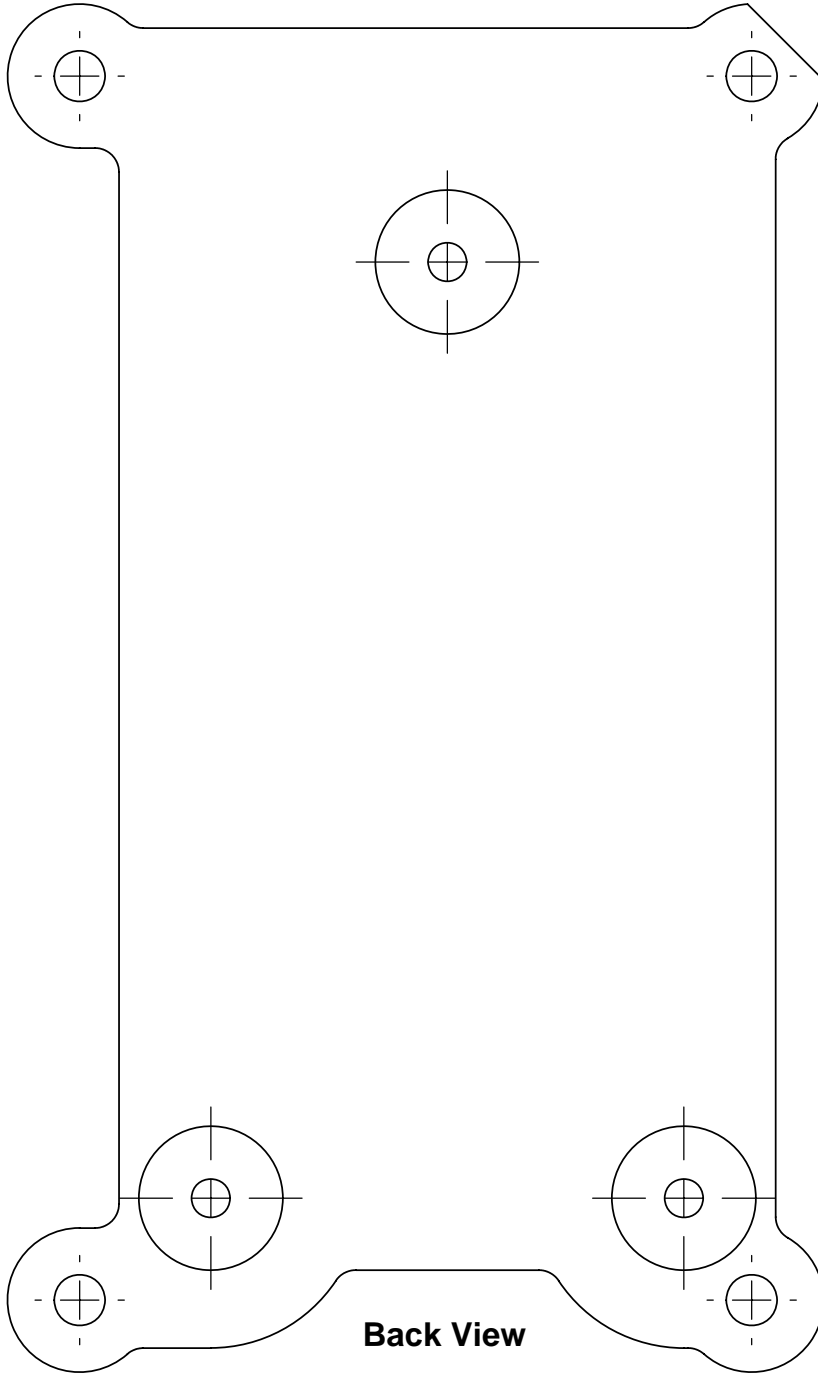
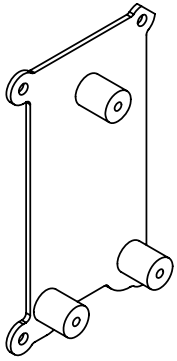

Back View

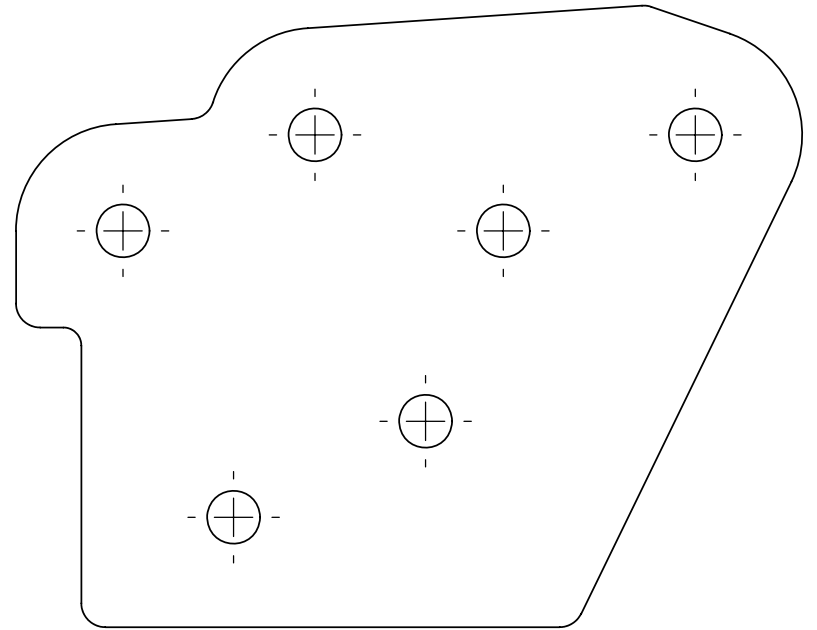
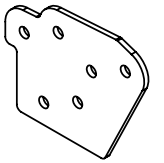

Front View

PROPRIETARY AND CONFIDENTIAL

THE INFORMATION CONTAINED IN THIS DRAWING IS THE SOLE PROPERTY OF SwitzerC. ANY REPRODUCTION IN PART OR AS A WHOLE WITHOUT THE WRITTEN PERMISSION OF SwitzerC IS PROHIBITED.

74911 CDI to MSD Plate Rev 00

SCALE: 1:1

SHEET 3 OF 3

5

4

3

2

1